

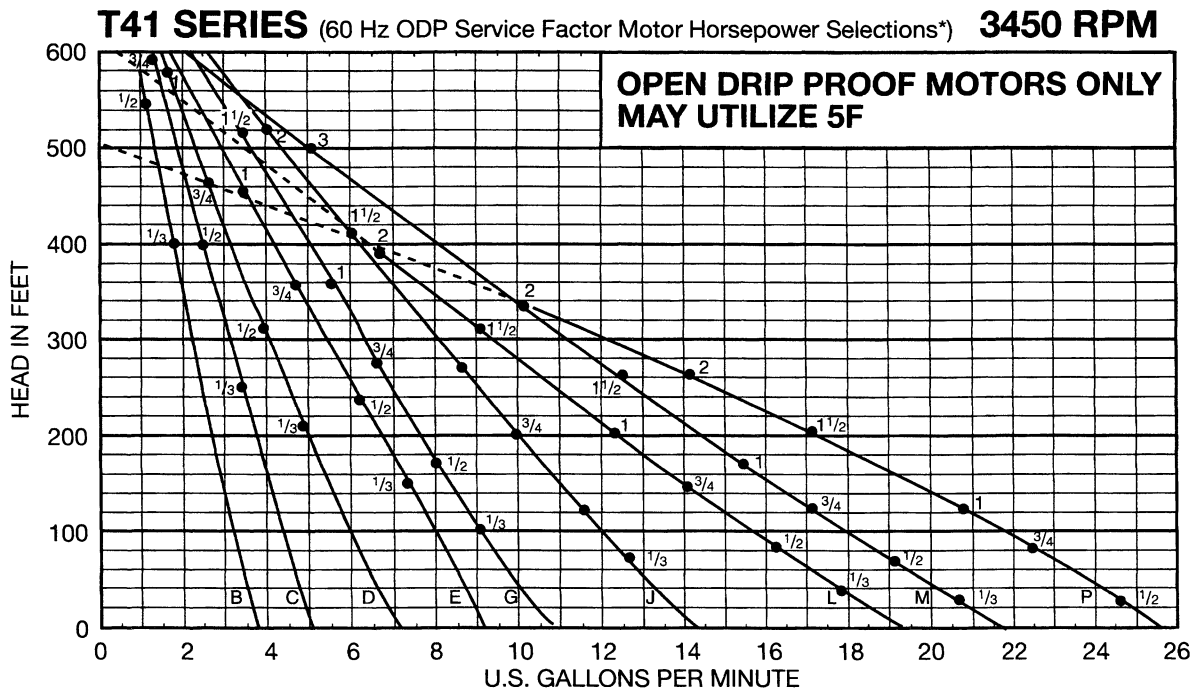

Selection Chart 3500 RPM MTH Series T41
Regenerative Turbine Pump

PSI x 2.31 = Head in Feet

Head in Feet	U.S. Gallons Per Minute – SP, GR, 1.0									
	2	4	6	8	10	12	14	16	18	20
	Model-HP	Model-HP	Model-HP	Model-HP	Model-HP	Model-HP	Model-HP	Model-HP	Model-HP	Model-HP
50	T41B-1/3	T41C-1/3	T41D-1/3	T41E-1/3	T41G-1/3	T41J-1/3	T41L-1/2	T41L-1/2	T41M-1/2	T41P-3/4
100	T41B-1/3	T41C-1/3	T41D-1/3	T41E-1/3	T41J-1/2	T41J-1/2	T41L-3/4	T41M-3/4	T41M-3/4	T41P-1
150	T41B-1/3	T41C-1/3	T41E-1/2	T41G-1/2	T41J-3/4	T41L-1	T41M-1	T41M-1	T41P-1 1/2	
200	T41B-1/3	T41D-1/3	T41E-1/2	T41J-1	T41J-3/4	T41L-1	T41M-1 1/2	T41P-1 1/2		
250	T41B-1/3	T41D-1/2	T41E-3/4	T41J-1	T41L-1 1/2	T41M-1 1/2	T41P-2			
300	T41B-1/3	T41D-1/2	T41G-1	T41J-1 1/2	T41M-2	T41P-3				
350	T41C-1/2	T41E-3/4	T41J-1 1/2	T41L-2	T41M-3					
400	T41C-3/4	T41E-1	T41J-1 1/2	T41M-3						
450	T41C-3/4	T41G-1 1/2	T41M-3							
500	T41C-3/4	T41G-1 1/2								



*Horsepower data is valid for 1.0 specific gravity fluids only.

Model T41 B, C, D, E, G, J, L,
 M, & P
 HI S. F. Motors / 3500 RPM

When selecting horsepower,
 always use horsepower dot
 above your rated point on the
 lettered impeller selection line.

Example: 4 GPM at 200 TDH
 would be a size T41D with
 1/3 HP.

PSI x 2.31 = Total Dynamic
 Head in Feet

NOT FOR CONSTRUCTION, INSTALLATION OR APPLICATION PURPOSES UNLESS CERTIFIED.								
CERTIFIED FOR:								
CUSTOMER ORDER NO:			IDENTIFICATION NO:			FLANGES		
PUMP DATA	SIZE	MODEL	CURVE NO.	GPM	HEAD (FT)	ROTATION	SUCTION	DISCHARGE
	HP	RPM	VOLTS	PHASE	HERTZ	FRAME SIZE	ENCLOSURE	
SHOP ORDER:			CERTIFIED BY:			DATE		



February 2001
Supersedes 04/00 issue

Horizontal Close Coupled

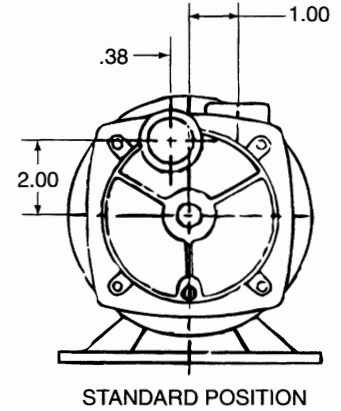
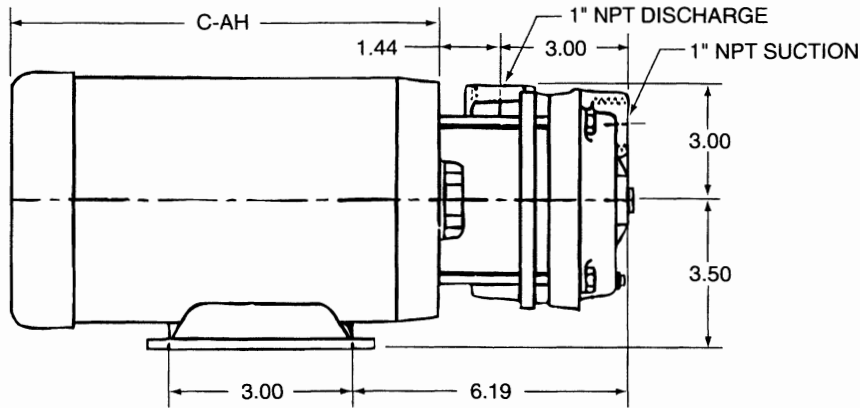

MOTOR DIMENSIONS			
Motor HP	Enc.	C-AH 208-230/480	C-AH 115/208-230
56C 1/3 HP	ODP	7.25	7.60
	TEFC	7.81	8.75
56C 1/2 HP	ODP	8.84	10.50
	TEFC	7.81	9.60
56C 3/4 HP	ODP	9.02	10.80
	TEFC	8.63	9.75
56C 1 HP	ODP	9.39	8.75
	TEFC	9.39	10.60
56C 1 1/2 HP	ODP	9.77	10.52
	TEFC	10.80	11.84
58C 2 HP	ODP	10.50	10.38
	TEFC	10.90	11.32
58C 3 HP	ODP	11.50	11.52
	TEFC	12.00	

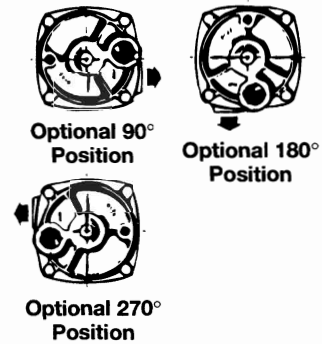

STANDARD MATERIALS:

- | | |
|---------------|--------------------|
| MOTOR BRACKET | CAST IRON ASTM A4B |
| COVER | CAST IRON ASTM A4B |
| IMPELLER | BRONZE ASTM B62 |
| SLEEVE | BRONZE ASTM B62 |
| "C" RINGS | BUNA N |
| SEALS | BUNA/NI-RESIST |

LIMITATIONS:

- DISCHARGE PRESSURE300 PSI
- * SEAL PRESSURE200 PSI
- * SUCTION PRESSURE (MIN)28" HG Vac.
- SPEED3800 RPM
- * SUCTION PRESSURE: PLUS 50% OF DIFFERENTIAL PRESSURE
- TEMPERATURE
- STANDARD CONSTRUCTION-20°F
- NI-RESIST SEAL WATER+230°F