



August 07

Supersedes all previous issues

CONCENTRIC REDUCER

INLET CONNECTION 150# F.F. PER ANSI B16.1
OUTLET CONNECTION 150# F.F. PER ANSI B16.1
BODY MATERIAL CAST IRON

FLANGE SIZE		C	WT	MAX W.P.
A	B			
3	2	6.00 (152.4)	16	175 PSI
3	2 1/2	6.00 (152.4)	19	
4	2	7.00 (177.8)	24	
4	3	7.00 (177.8)	28	
5	3	8.00 (203.2)	32	
5	4	8.00 (203.2)	39	
6	3	9.00 (228.6)	39	
6	4	9.00 (228.6)	47	
6	5	9.00 (228.6)	50	
8	6	11.00 (279.4)	77	
10	8	12.00 (304.8)	120	150 PSI
12	10	14.00 (355.6)	180	
14	10	16.00 (406.4)	280	
14	12	16.00 (406.4)	300	

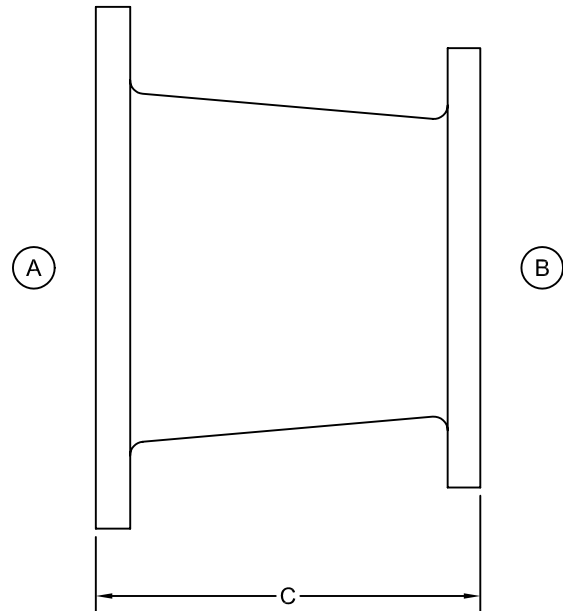

NOT FOR CONSTRUCTION, INSTALLATION OR APPLICATION PURPOSES UNLESS CERTIFIED		
CERTIFIED FOR:		
CUSTOMER ORDER NO.:	TAG NO.	
SHOP ORDER:	CERTIFIED BY:	DATE:

DIMENSIONS IN INCHES (mm)



CONCENTRIC REDUCER

INLET CONNECTION 250# F.F. PER ANSI B16.1
OUTLET CONNECTION 250# F.F. PER ANSI B16.1
BODY MATERIAL CAST IRON

FLANGE SIZE		C	WT	MAX W.P.
A	B			
3	2	6.00 (152.4)	36	400 PSI
3	2 1/2	6.00 (152.4)	39	
4	2	7.00 (177.8)	44	
4	3	7.00 (177.8)	48	
5	3	8.00 (203.2)	52	
5	4	8.00 (203.2)	59	
6	3	9.00 (228.6)	59	
6	4	9.00 (228.6)	67	
6	5	9.00 (228.6)	70	
8	6	11.00 (279.4)	97	
10	8	12.00 (304.8)	140	
12	10	14.00 (355.6)	200	300 PSI
14	10	16.00 (406.4)	300	
14	12	16.00 (406.4)	320	

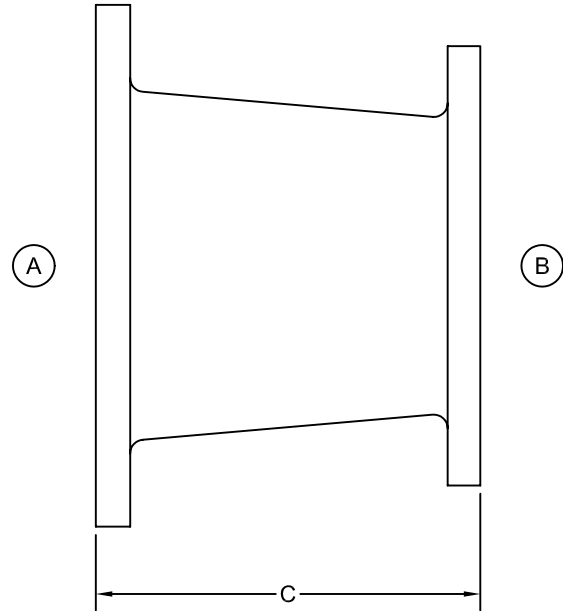

NOT FOR CONSTRUCTION, INSTALLATION OR APPLICATION PURPOSES UNLESS CERTIFIED		
CERTIFIED FOR:		
CUSTOMER ORDER NO.:	TAG NO.	
SHOP ORDER:	CERTIFIED BY:	DATE: